



Model	RPM	Hz	HP	kW	SCFM	Pressure		Vacuum		Noise Level	Net Weight	
						mbar	"H2O	mbar	"H2O		kg	lbs
RB63	3450	60	6.1	4.6	230	380	153	380	153	79 db(A)		
	2850	50	4	190	380	153	360	145	75 db(A)			
RB63	3450	60	8.5	6.3	230	540	217	425	171	79 db(A)		
	2850	50	5.5	190	520	209	420	169	75 db(A)			
RB63	3450	60	11.5	8.5	230	675	271	450	180	79 db(A)		
	2850	50	7.5	190	590	237	440	177	75 db(A)			

*Refer to curves below for detailed performance data. Data subject to change without notice. Actual performance may vary by ±10%.

STANDARD FEATURES

- Housing - Aluminum
- Impeller - Aluminum, dynamically balanced
- Direct drive impeller
- Shock absorbing mounting base
- Quiet operation - below OSHA limits
- Inlet & outlet silencers included
- Regreasable bearing
- 40 Deg C ambient
- Performance tested ANSI/AMCA210-85

TECHNICAL DATA

- [Available online www.all-star-usa.com]
- Performance Temperature Rise Curves
 - AutoCad files
 - Parts List

NOTE: The RB63 replaces the HB-6301

ACCESSORIES

Note: To obtain warranty coverage on the blower a relief valve and filter are required.

Pressure Relief Valve RV-02 for pressures of 110 to 236"H2O

Pressure Relief Valve RVA-02 for pressures of 110 to 236"H2O

Vacuum Relief Valve RV-02 for vacuums of 110 to 236"H2O

Vacuum Relief Valve RVA-02 for vacuums of 110 to 236"H2O

Pressure Intake Air Filter F231P-200

Vacuum Air Filter CSL-851-200HC

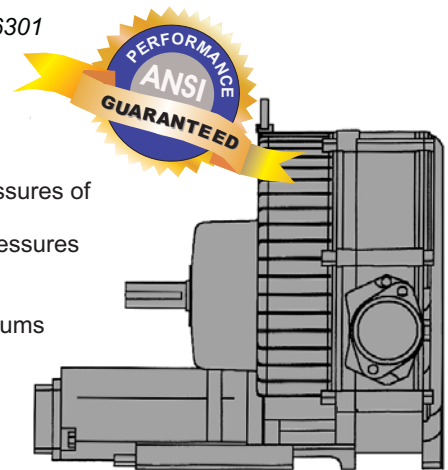

RoHS Compliant

PRESSURE DATA CURVES ±10%

[See reverse side for Vacuum Curves]

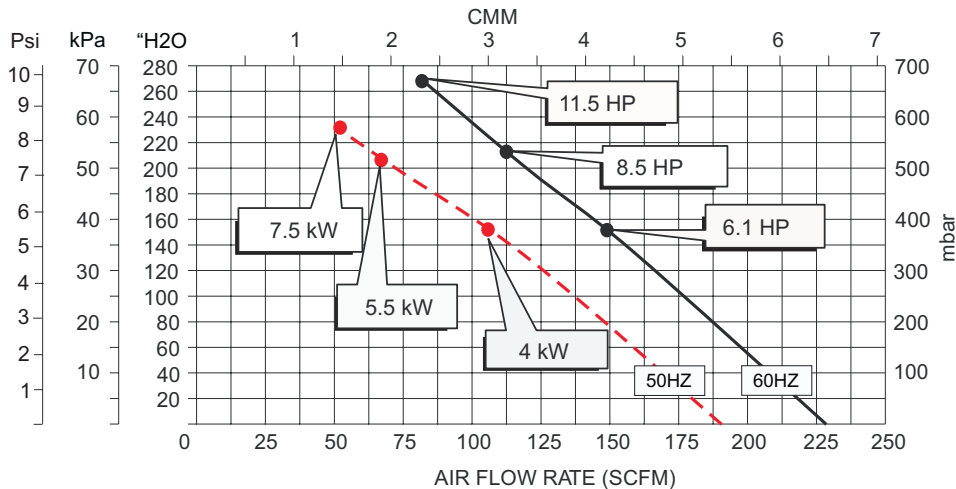

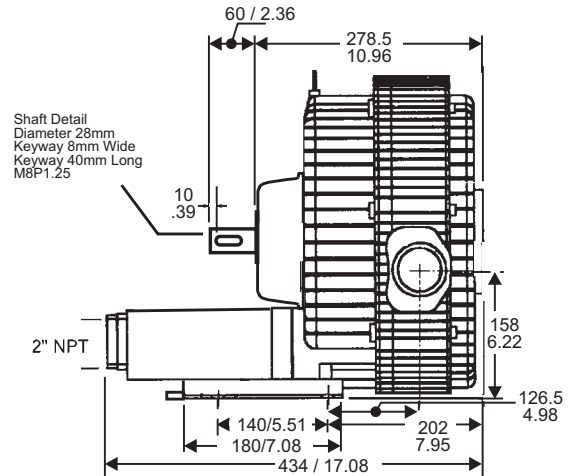
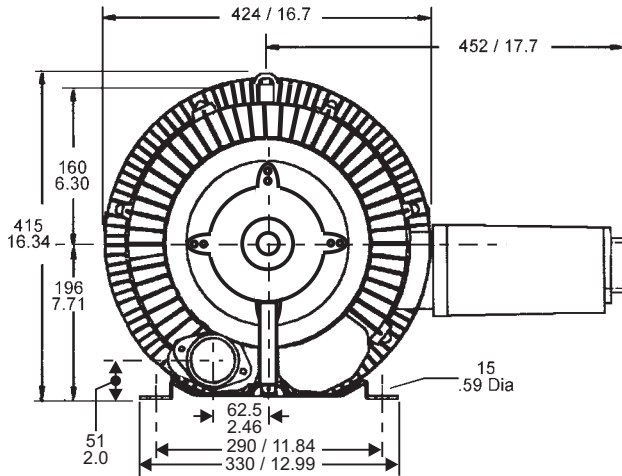

VACUUM DATA CURVES

